



PRODUCT CODE:

FH-55

FH-56-LH

FH-57-RH



PRODUCT CODE:

FH-58-LH

H-59-RH

FH-60-LH

FH-61-RH



PRODUCT CODE:

FH-62

FH-63

FH-64

FH-65

FH-66

FH-67

FH-68

FH-69

304 Grade Stainless Steel Flag Hinge

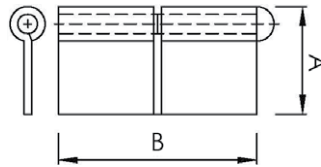

PRODUCT CODE	A	B	THICKNESS	PIN
FH-55	28	52	2	4.8
FH-56-LH	50	75	2	4.8
FH-57-RH	50	75	2	4.8

304 Grade Stainless Steel Lift Off Hinge

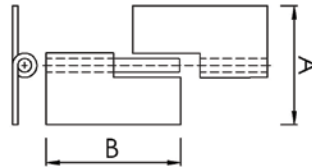

PRODUCT CODE	A	B	THICKNESS	PIN
FH-58-LH	44	50	2	4
FH-59-RH	44	50	2	4
FH-60-LH	50	76	2	4
FH-61-RH	50	76	2	4

304 Grade Stainless Steel Continuous Hinge

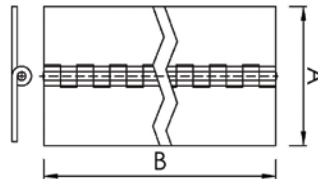

PRODUCT CODE	A	B	THICKNESS	PIN
FH-62	27	1800	0.9	3
FH-63	32	1800	1.2	3
FH-64	38	1800	1.2	3
FH-65	50	1800	1.2	3
FH-66	57	1800	1.5	4.5
FH-67	63	1800	1.5	4.5
FH-68	76	2160	1.5	4.5
FH-69	127	2000	1.5	4.5

All measurements in mm.



STAINLESS STEEL EVOLUTIONS
Innovate · Create · Deliver

Details accurate at time of print. Whilst all care has been taken in compiling this information, designs & dimensions shown are indicative only and should not be relied upon without prior approval.